

## CREW DOOR ENTRANCE STEPS - MAINTENANCE PRACTICES

### 1. General

- A. The crew door entrance steps consist of metal, ladder-like steps attached to the floorboard just inside each crew door. The steps are hinged at the center, fold in half, then pivot at the floorboard attachments upside down to their stowed position just inside the crew doors.

### 2. Crew Door Step Assembly Removal/Installation

- A. Remove Crew Door Step Assembly (Refer to Figure 201).
  - (1) Remove nuts (1), lockwashers (2), washers (3), spacers (4), washers (9), and bolts (10) attaching crew steps to mounting brackets (7) on floorboard.
- B. Install Crew Door Step Assembly (Refer to Figure 201).
  - (1) Align holes in step assembly with holes in mounting brackets (7).
  - (2) Install bolt (10) with washer (9) and spacer (10) through mounting bracket (7), then install spacer (4), washer (3), locknut (2), and nut (1).

### 3. Crew Door Step Disassembly/Assembly

- A. Disassemble Crew Door Step (Refer to Figure 201).
  - (1) Remove step assembly from airplane.
  - (2) Remove lower arms (14) by removing nut (22), lockwasher (21), washer (20), spacer (19), washer (24), and bolt (25).
  - (3) Remove screws (17) attaching upper step (12) to upper arms (11).
  - (4) Remove screws (17) attaching lower step (15) to lower arms (14).
- B. Assemble Crew Door Step (Refer to Figure 201).
  - (1) Position lower step (15) into slots in lower arms (14) and install screws (17).
  - (2) Position upper step (12) into slots in upper arms (11) and install screws (17).
  - (3) Align holes in lower arms (14) with holes in upper arms (11), install bolts (25) with washers (24), then install spacer (19), washer (20), lockwasher (21), and nut (22).
  - (4) Install step assembly on airplane.

### 4. Safety Walk Replacement

- A. Replace Safety Walk.
  - (1) Remove old safety walk material.
  - (2) Clean surface with Acetone or equivalent.
  - (3) Remove backing from new Safety Walk.
  - (4) Apply Safety Walk material to step.
  - (5) Form fillet around edges with 3M Edge Sealing Compound (or equivalent) per instructions on container.

Figure 201 : Sheet 1 : Crew Door Entrance Step Installation

A22261

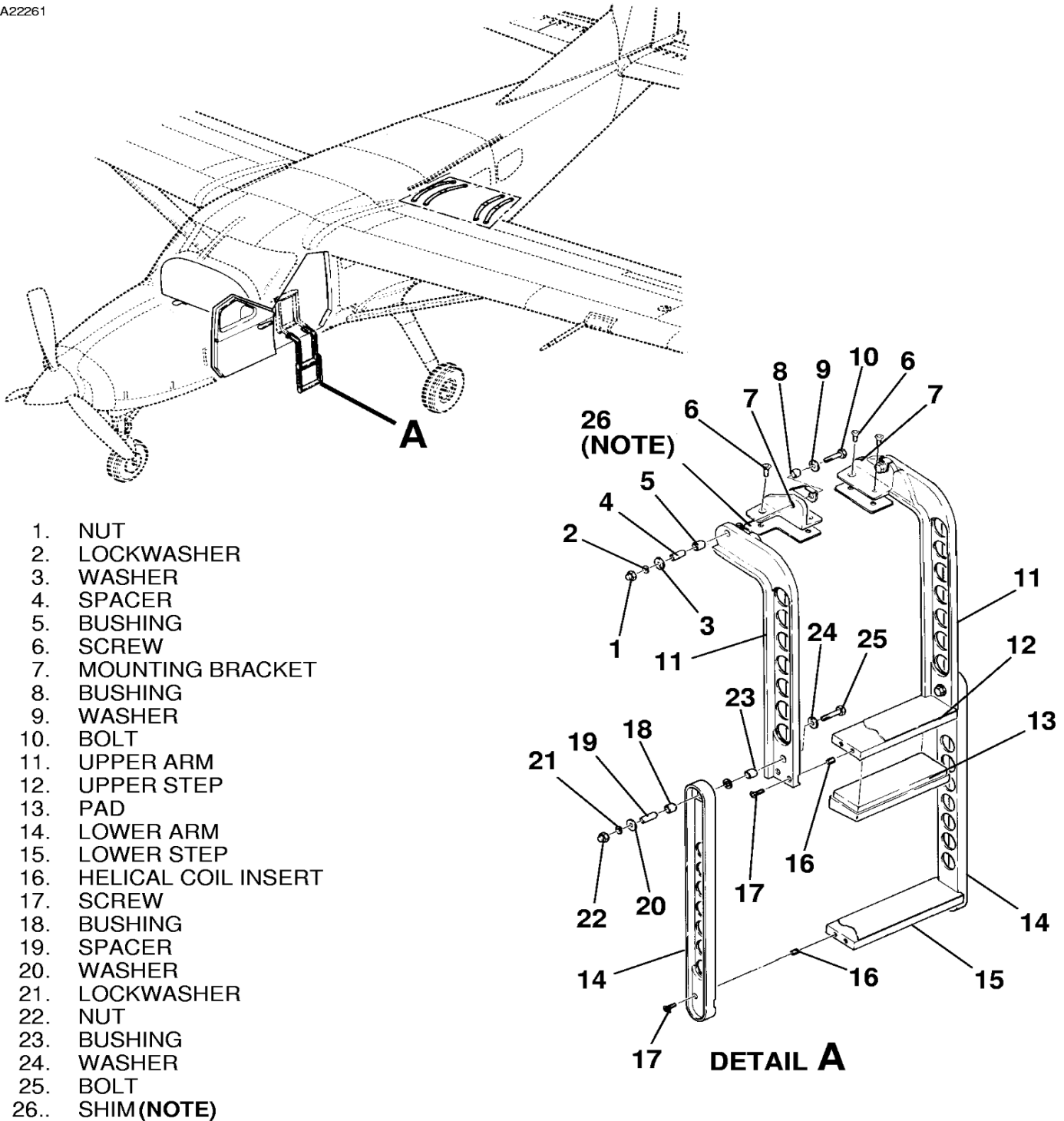

- 1. NUT
- 2. LOCKWASHER
- 3. WASHER
- 4. SPACER
- 5. BUSHING
- 6. SCREW
- 7. MOUNTING BRACKET
- 8. BUSHING
- 9. WASHER
- 10. BOLT
- 11. UPPER ARM
- 12. UPPER STEP
- 13. PAD
- 14. LOWER ARM
- 15. LOWER STEP
- 16. HELICAL COIL INSERT
- 17. SCREW
- 18. BUSHING
- 19. SPACER
- 20. WASHER
- 21. LOCKWASHER
- 22. NUT
- 23. BUSHING
- 24. WASHER
- 25. BOLT
- 26.. SHIM(NOTE)

**NOTE:** ON AIRPLANES 20800082 AND ON, INSTALL SHIMS (26) UNDER STEP BRACKET (7) AS REQUIRED TO MAKE POSITIVE CONTACT WITH ARM BEFORE ARM COMES INTO CONTACT WITH FLOOR.

26141051  
 A26143020